

Trail Camera

Model: WiFi900Pro

[Use Manual](#)



WiFi + APP



Bluetooth



30FPS



30MP



H.265

Viewing

Built-in screen TFT 2.0"

Power source

Alkaline Battery 1.5V AA Battery*8 Rechargeable
Lithium Battery lithium AA battery DC 12V 1A
External Power Jack (3.5x1.3mm)

Detection system

Motion Sensor 1x PIR
Detection Angle 120°
Detection Range Adjustable from 1 to 98 Ft
Trigger Speed 0.2second
Delay between each detection 1/5/10/30 seconds, 1/5/10/30 minutes

Night time illumination system

Infrat LEDs 44pcs LEDs
Flash Range < 98 Ft
Exposure Auto / 100 / 200 / 400

Optical field of view

120°

Dimensions

150mm" x 100mm" x 60mm"

Recommendations

Operating temperature (-4°F to + 158°F) (-20°C to + 70°C)

Waterproof level

IP 66

SPECIFICATIONS

Photo recording

Photo resolution	30MP/24MP / 20MP / 16MP / 12MP
File format	.JPG
Time lapse mode	5min / 10min / 30min / 60min
Multi-shot mode	Up to 9 photos per detection
Stamp (photos and video)	Date, time, temperature (°C /°F) and moon phase Camera/Video/Camera & video/Time lapse
Capture mode	

Video recording

Video resolution	4K / 2K/ 1080P / 720P / VGA(480P)
File format	.MP4 / H.265
Video length	5s /10s / 30s / 60s / 90s
Capture mode	Colorful mode at daytime, black and white mode at night

WiFi / APP / Bluetooth

Scan QR code to Download Bluetooth WiFi On / Off
WiFi Vision Distance 50M Bluetooth Connection Distance 5M



App (IOS)
WiFiCameraSum



App (Android)
WiFiCamera

Memory storage

- Support
- Internal memory: none
 - External memory: Micro SD card (up to 256GB, Not included)
- 1 -

THE BASICS

High power invisible LED

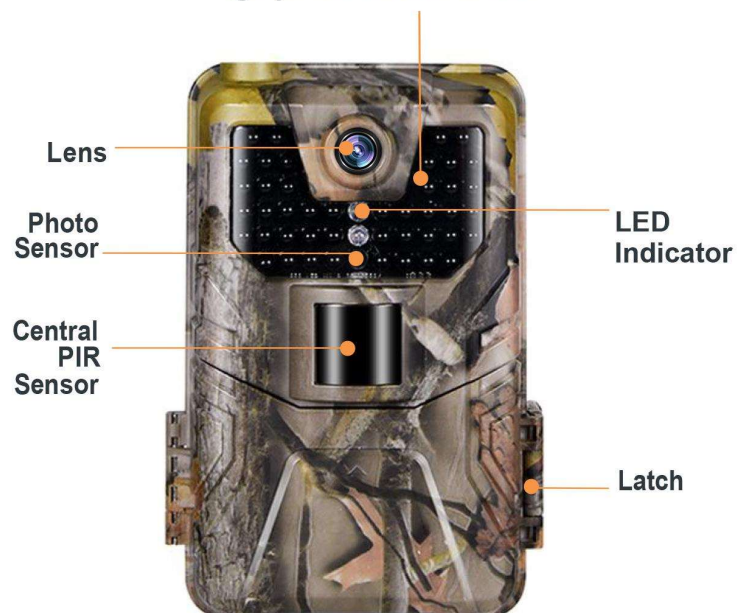

INSTALLATION

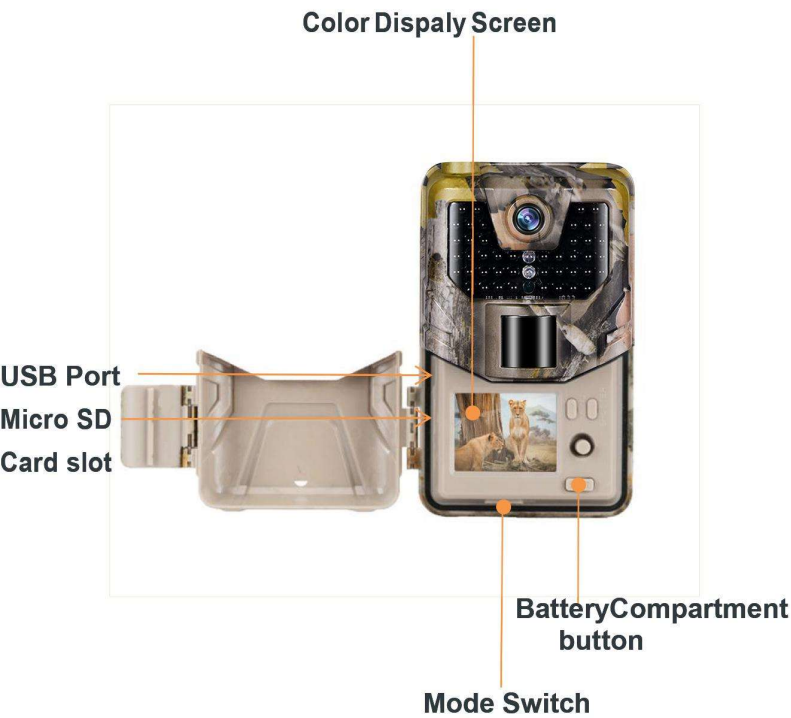

- 4 -

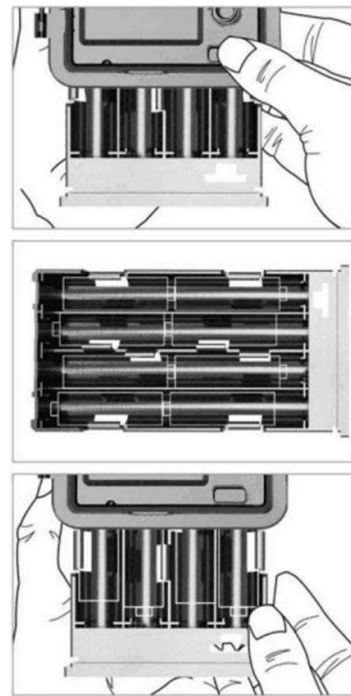

Step 1

- 1 Open the battery cover and insert 8 batteries(AA) following to the positive and the negative battery sign. Close the battery cover to Resist water and dust

⚠WARNING

Be Sure to put AA batteries in the correct direction. Inserting batteries incorrectly will cause permanent damage.

- 5 -

Step 2

Insert Micro SD(Not included) memory card to Trail Camera.



Step 3

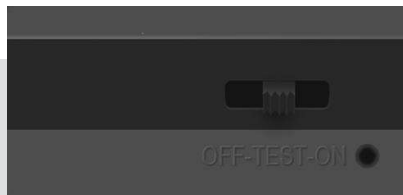

- 1 Slide the mode switch form **OFF** to **TEST** to activate the camera and view the user setup screen.

2 And then slide the mode switch form **TEST** to **ON**.

3 The camera will start working after 10 seconds countdown, meanwhile the red indicator light will blink.

- 6 -

Step 4

Scan the QR codes below or search for "WiFiCameraSum" on the Apple appstore or search for "WiFiCamera" on the Google Play to download the app.

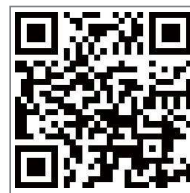

IOS



Android

Step 5

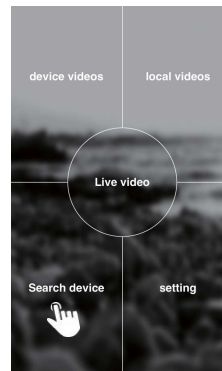

- 1 Open the APP on your cellphone and tap "Search Device" at the left lower corner

- 2 select "GCBT40" and then tap "Connect" to connect your phone and camera with Bluetooth. You can see the camera flashing yellow light one time and then flashing blue light.

- 7 -

GETTING START

Step 7

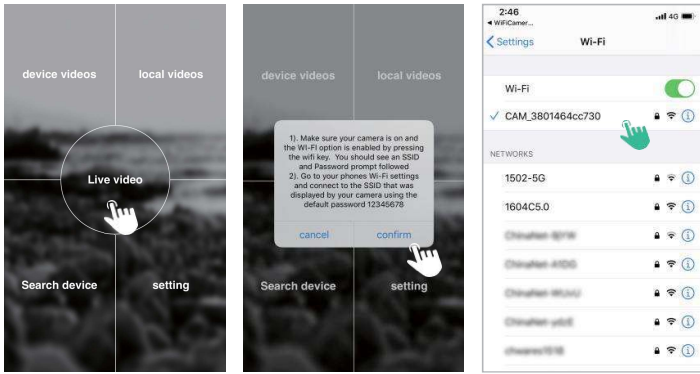

- 1 Back to the main page of app and then tap "Live video".
- 2 Go to WiFi setting on your phone, select
- 3 "CAM_XXXXXXXXXX" Enter password "12345678".
(WiFi name and password can be changed in the APP when connected)

- 8 -

Night



Day



- 9 -

EXTERNAL POWER SUPPLY

Use 12V DC Power source (Not included)



OPERATING BUTTON



- MENU** Menu Button -- Menu Setting
- REPLAY** Shutter Button -- Start/End Video Recording or Photo Taking
- ↑** Video Button -- Video Recording Mode
- ↓** Camera Button -- Photo Mode
- ▶** Replay Button -- Replay Mode
- WiFi Button: ON/OFF WiFi

- 10 -

SETUP MENU

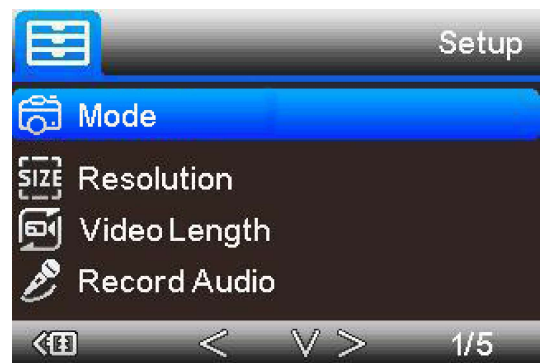

Setup	Sub Menu	Description
Mode	Camera, video, camera & video, Timelapse	Picture, video, picture and video, taking picture regular
Resolution	4K, 2K, 1080P, 720P, WVGA(480P)	Video Resolution
Video Length	5/10/30/60/90 Seconds	Each Video max 90 sec, default 10sec
Record Audio	On / Off	Video With Sound

- 11 -

Setup	Sub Menu	Description
Image Size	30MP/24MP/20MP/16MP/12MP	Image resolution
Interval	1/5/10/30sec,1/5/10/30min	Max 30 minutes delay
Time Lapse	5/10/30/60 minutes	Take pic every 5min
Sequence	1/3/6/9 pictures	Max 9 pics one shot
ISO	Auto/100/200/400	Exposure level
Over write	On / Off	Cycle Recording
PIR Sensitivity	High/Medium/Low	Adjust PIR sensitivity
Language	EN/FR/DE/IT/ES/POR/HRV/DAN/SVE/SUO/POL/ /PYC	Adjust PIR sensitivity
Frequency	50HZ / 60HZ	Screen refresh rate
Camera ID	CAM000	6 numbers or letters
Password	On / Off	4 numbers
Working Timer	00:00:00 to 23:59:59	N/L
Date / Time	DD/MM/YY	N/L
Format	OK / Cancel	Format memory card
Default Setting	OK / Cancel	Back to default

In The box



▲Camera

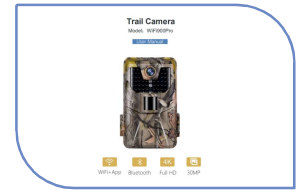

▲Manual



▲Mounting Strap



▲Card reader

TROUBLESHOOTING

Q: What is the range of WiFi and Bluetooth?

A: The range of camera WiFi is about 98Ft at forest or indoor and 328Ft at open space. The range of camera Bluetooth is between 16 to 26 Ft.

Q: How close do i need to be to turn the wifi on using the bluetooth?

A: The maximum distance of the camera's Bluetooth switch is 5 meters

Q: Does it have a connection to be wired for 9vdc or 12vdc instead of battery?

A: Yes, you can use 9vdc for this camera, there is a power connector in the box, dedicated to the external power supply.
Recommend using 8*1.5V AA batteries in this trail camera to obtain maximum battery life.(NOT INCLUDED)

Q: Can you change WiFi name and password of the camera?

A: Yes, you can change different WiFi name and your own password by app on phone.

Q: Can you connect to your in-home WiFi and the internet provided the camera

A: WiFi900 Bluetooth trail camera connects with the phone's WiFi, not in-home WiFi/Internet. Download the APP on your phone and then connect with WiFi. You can adjust the setting and check the photo /video on the phone directly.

Q: Is the app available for iPhone?

A: Yes, Trail Camera use "WiFiCameraSum" APP for Apple Store and "WiFiCamera" APP for Google Play, it's available for Android and IOS system phone.